

**EROSION CONTROL NOTES:**

To comply with Best Management Practices, construction will occur between the dates of May 1 and Oct. 15, or during the construction season as determined by the Nevada County Building Department.

1. All excavated areas shall be kept watered or covered with a palliative to prevent emission of fugitive dust. Dust and mud control shall be provided at all times including evenings, weekends and holidays. At least one mobile unit with a minimum capacity of 1000 gallons shall be available at all times for applying water on the affected areas. Water shall be obtained from a source approved by the Northern Sierra Air Quality Management District.

2. Seed, fertilizer and mulch shall be applied between Sept. 15 and Oct. 15. Removal of native vegetation shall be minimized.

3. Seed, fertilizer and mulch shall be applied to all disturbed soils and all exposed cut and fill slopes not protected by rock in the following rates:

SEED:  
Blando Brome -- 12 lbs./ac.  
Zorro annual fescue -- 4 lbs./ac.  
Hykon Rose Clover (inoculated) -- 9 lbs./ac.

FERTILIZER:  
Ammonium Phosphate (16-20-0) -- 300 lbs./ac.

MULCH:  
Clean Straw -- 2.5 lbs./ac.

Slopes with glazed or smooth surfaces shall be scarified to a depth of 2-4 inches to provide an adequate seed bed.

\*\* Legumes shall be inoculated with appropriate bacteria at accepted rates at time of seeding.

Seed and fertilizer shall be applied using broadcast method on slopes greater than 2:1. Other measures such as netting or tackifiers shall be utilized to hold materials in place until vegetation is established.

4. If permanent erosion control measures are not installed by Oct. 15 of construction season, temporary measures such as straw bale sediment barriers, check dams, sediment traps shall be employed no later than Nov. 1. The actual locations for specific measures may be determined in the field after consulting with the Nevada County Resource Conservation District.

5. Cut and fill quantities shall be held to a minimum.

6. Unnecessary soil disturbance shall be minimized by restricting heavy equipment activity and vehicular movement to the immediate area of the planned road improvements.

7. All disturbed areas shall be seeded and mulched immediately after being constructed to final configurations. If at any time during construction, rainfall is anticipated prior to reaching the final configuration for the graded area, the disturbed area(s) shall be seeded and mulched to minimize erosion potential during rainy periods. Seeding and mulching shall be anchored by punching.

8. Seeded areas shall be repaired, reseeded and mulched as soon as possible after being damaged.

9. Straw bale dikes shall be installed at the toe of all cut and fill slopes as required by Nevada County. Installation shall be per the specifications contained in Section 1.D of the erosion & sediment control guidelines Oct. 1991.

10. Straw bale dikes shall be cleaned after significant sediment deposits have been accumulated. Spoil material will be deposited so that it will not directly reenter the sedimentation barrier or cause further sedimentation offsite. The spoil heap shall be seeded when formed and whenever more deposits are added.

11. All erosion control measures shall be inspected and repaired as required at the end of each workday, and additionally after each storm. All erosion control measures shall be fully implemented prior to start of work. New slopes steeper than 3:1 shall be covered with jute matting, in addition to standard erosion control practices. Slopes 3:1 or flatter shall be covered with straw in lieu of the jute matting.

12. Provide rock lining for ditches on all grades exceeding 5%.

13. All materials to be on site prior to start of work.

14. All erosion control to be performed during excavation.

15. All banks 3:1 (or steeper) will be matted and monitored during storm activity.

16. Excess soil to be distributed at depths not to exceed 1 foot, then mulched and seeded.

**DRIVEWAY 1" = 40' VERT.  
PROFILE 1" = 50' HORIZ.**

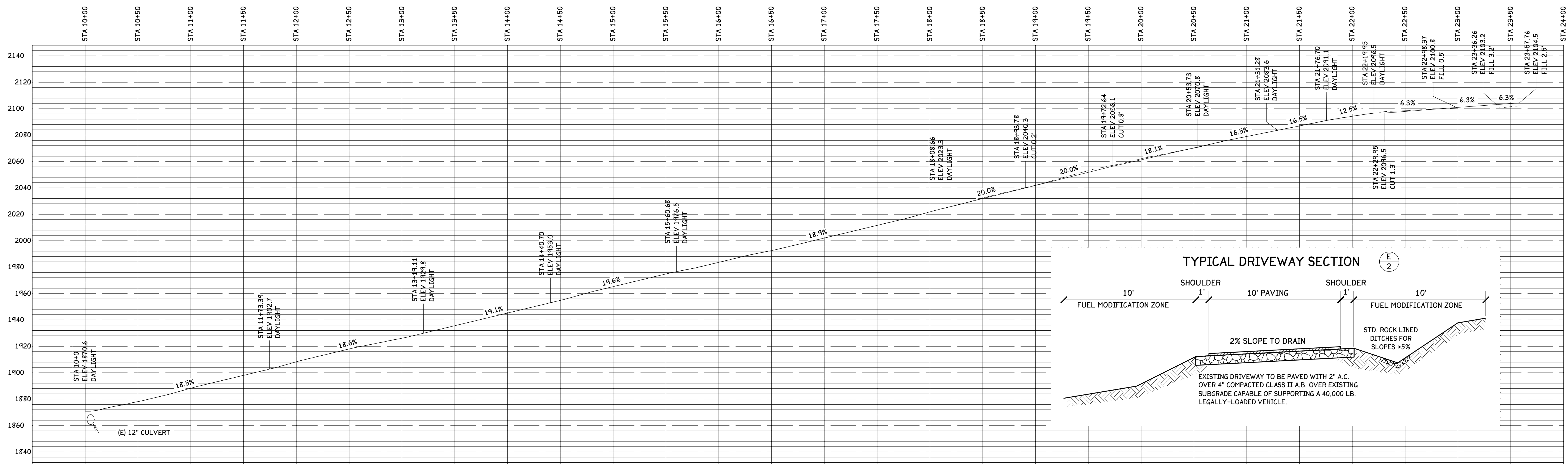

**CONSTRUCTION NOTES:**

1. All construction shown on these plans shall be in conformance with the State of California Department of Transportation, standard specifications 1992 or Nevada County improvement standards and specifications except as modified herein. Any reference to standard specs. shall mean said specifications.

2. Contractor shall notify the Nevada County Department of Transportation 48 hours prior to any work.

3. At his own expense, the contractor shall provide all permits, certificates and licenses required by law.

4. All fills shall be constructed to 90% relative compaction, except that the upper 2.5' shall be constructed to 95% relative compaction. All excavation areas shall be scarified to 6" below subgrade and replaced at 95% relative compaction. Compaction testing shall be in accordance with ASTM D-1557.

5. Any unsuitable material encountered during excavation activities shall be disposed of in accordance with standard specs. Section 19-2.02.

6. Contractor shall be responsible for verifying the location of all existing utilities, whether or not shown herein. Call Underground Service Alert (U.S.A.) before excavation.

7. All surfaces damaged by the actions of the contractor shall be restored to equal or better than original condition.

8. The contractor shall make all arrangements for construction water.

9. Corrugated metal pipes (CMP) shall be installed at a grade of no less than 1.0%.

10. Contractor shall chip all cleared vegetation removed from this project, unless written approval for other disposal methods is obtained from the air pollution control officer of the Northern Sierra Air Quality Management District.

11. Contractor shall provide compaction tests at his expense.

12. If any septic work is to be done, all driveway grading shall be completed prior to start of such work and septic system shall be staked and approved by County Environmental Health prior to any trenching. Call County Building/Environmental Health to request inspection.

**MATERIAL NOTES:**

1. Aggregate base shall be class 2, 3/4" maximum medium grading conforming to standard spec. section 26, placed at 95% relative compaction.

2. Asphalt concrete shall be type A, 3/4" maximum medium grading construction in accordance with standard specs. section 39, 93, and 94.

3. All concrete shall develop a minimum compressive strength of 2000 PSI at 28 days, and shall be class B conforming to Cal. Trans.; specs, section 73-1.01 & 90-1.01 (minor conc.) w/564lb/cy cement.

4. Corrugated metal pipe (CMP) shall be steel pipe in accordance with standard specs. Section 66. CSP or CMP shall be 12-gauge minimum.

5. Rock lining for ditches shall conform to no. 2 backing and the rock lining for the typical rock ditches shall conform to no. 1 backing placed using method b (no footing required) as specified in the standard specs.

**GENERAL NOTES:**

1. Any construction within the County Right-of-way shall be accomplished under an encroachment permit issued by the Nevada County Dept. of Transportation.

2. Contractor shall restore all road surfaces disturbed by construction activities to equal or better condition than existed prior to construction.

3. All construction plans shall advise contractors and construction personnel involved in any form of ground disturbance, i.e. utility placement or maintenance, grading, etc., of the remote possibility of encountering subsurface cultural resources. If such resources are encountered or suspected, work shall be halted immediately and the Planning Department contacted. A professional archaeologist shall be consulted to access any discoveries and develop appropriate management recommendations for archaeological resource treatment. If bones are encountered and appear to be human, California law requires that the Nevada County Coroner and the Native American Heritage Commission be contacted and, if Native American resources are involved, Native American Organizations and individuals recognized by the County shall be notified and consulted about any plans for treatment.

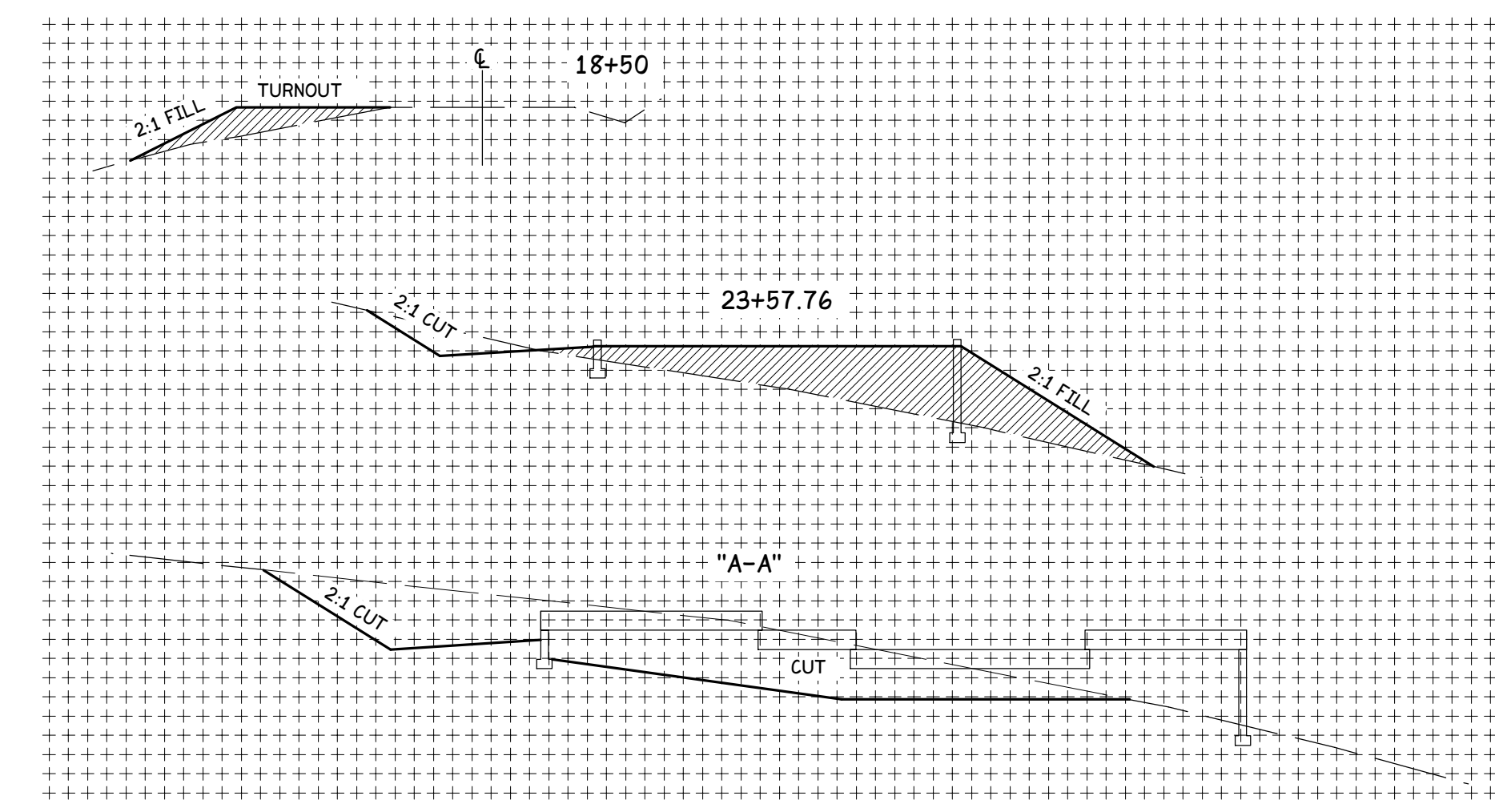

**SECTIONS 1" = 8' VERT.  
1" = 10' HORIZ.**

**Site Plan**  
FOR  
**Ron & Mary Ann Dunant**  
A portion of the NW 1/4 Sec. 6 T.14N. R.9E. MDM  
In the unincorporated territory of  
**NEVADA COUNTY, CALIFORNIA**  
May 13, 2006

**DETAILS AS PER  
NEVADA COUNTY  
STANDARD DRAWINGS**

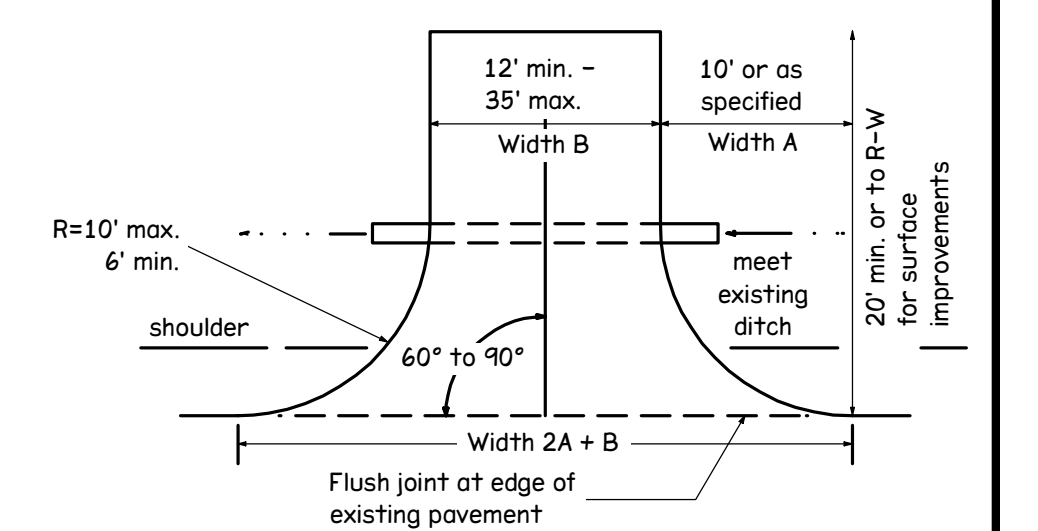

**ENCROACHMENT  
DETAIL**

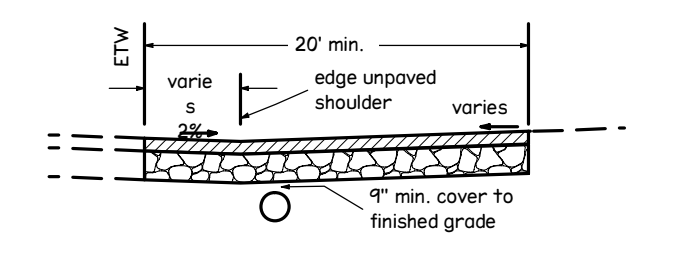

**ENCROACHMENT  
PROFILE**

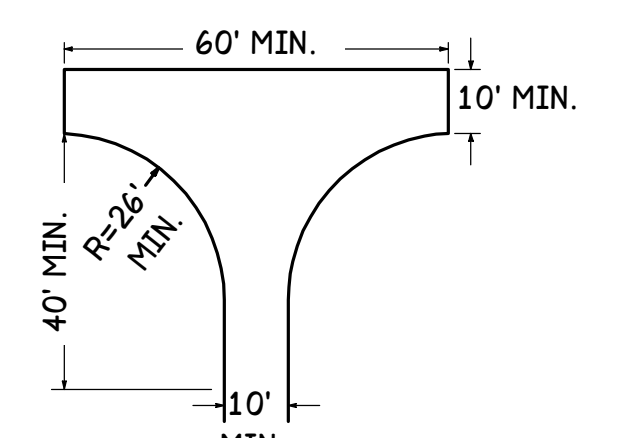

**HAMMERHEAD**

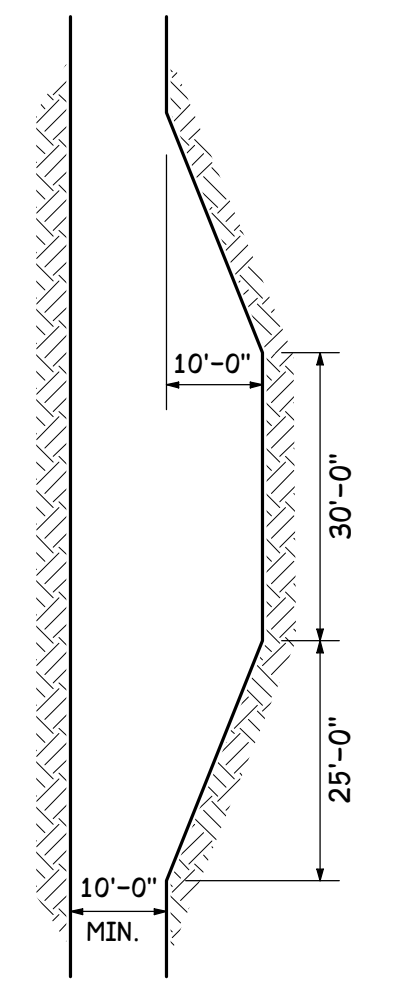

**TYPICAL  
TURNOUT**

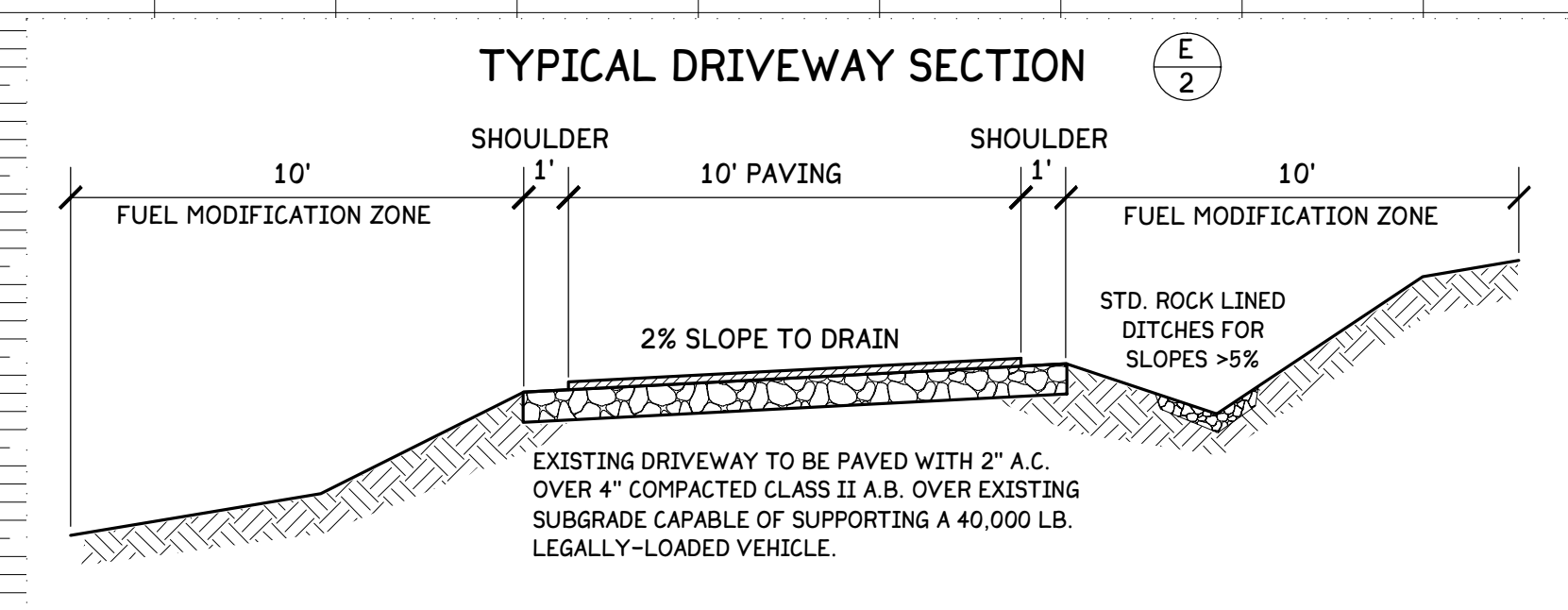

**TYPICAL DRIVEWAY SECTION**